

# PARKHILL PRIMARY SCHOOL

PHOOEY  
Architects

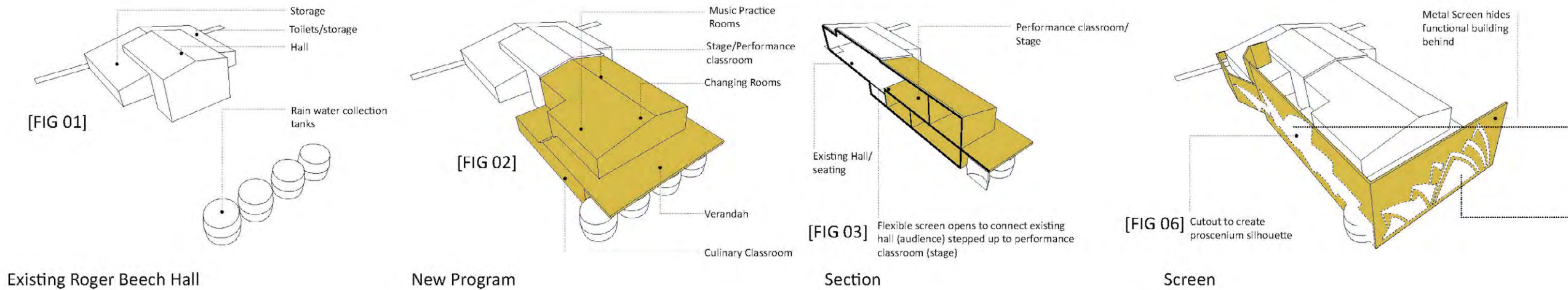

Existing Roger Beech Hall

New Program

Section

Screen



[FIG 04] School Logo

This project involves transforming the existing Roger Beech Hall [FIG 01] at Parkhill Primary School into a **Performing Arts Centre**. Currently this facility operates as a multi-purpose hall including a gymnasium, after school care, canteen, storage and amenities. Alterations and additions of the existing building will enable new function spaces including a performing arts classroom, music practice rooms, changing rooms and culinary classroom [FIG 02]. These internal spaces open to outside verandah areas to allow flexible learning. A performance theatre will be created by opening the multi-purpose hall (audience seating) to the performing arts classroom (stage with back of house) [FIG 03].

This project is created by Round 3 (non template buildings) **Building Education Revolution** under the Australian Government's Economic Stimulus Plan. To receive project funding, the original Brief included completion of the design, development, documentation under budget with school council approvals and government authority approvals within eight weeks.

The Parkhill Primary School motto is **nurturing success** – creating the opportunity to develop every student's personal growth and experiences [FIG 04]. In one's personal development does nature or nurture contribute more to personality? Do both types of factors play interacting roles for personal development? Would Jesus or Hitler be re-created if they were genetically cloned? What if you cloned the Sydney Opera House? [FIG 05] Would it be an exact replica twin building? Or what physical nature of its iconic form would remain? How would effects of the Building Education Revolution in suburban Melbourne nurture its experiences differently? Is this an appropriate solution for a city debating the necessity of a Sydney Opera House?

As **precedence**, the Sydney Opera House is an inspiring performing arts facility. It is a place where young musicians, dancers and actors identify, aspire and dream to perform at one day – as telecast to the nation by the winners of Australian Idol.

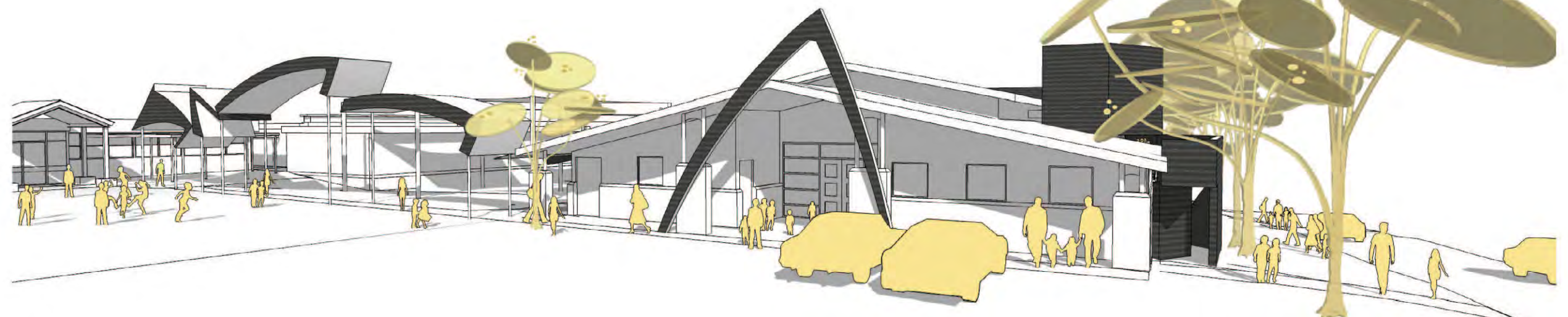

[FIG 10] Main Entrance to Roger Beech Hall (East)

# PARKHILL PRIMARY SCHOOL

PHOOEY  
Architects

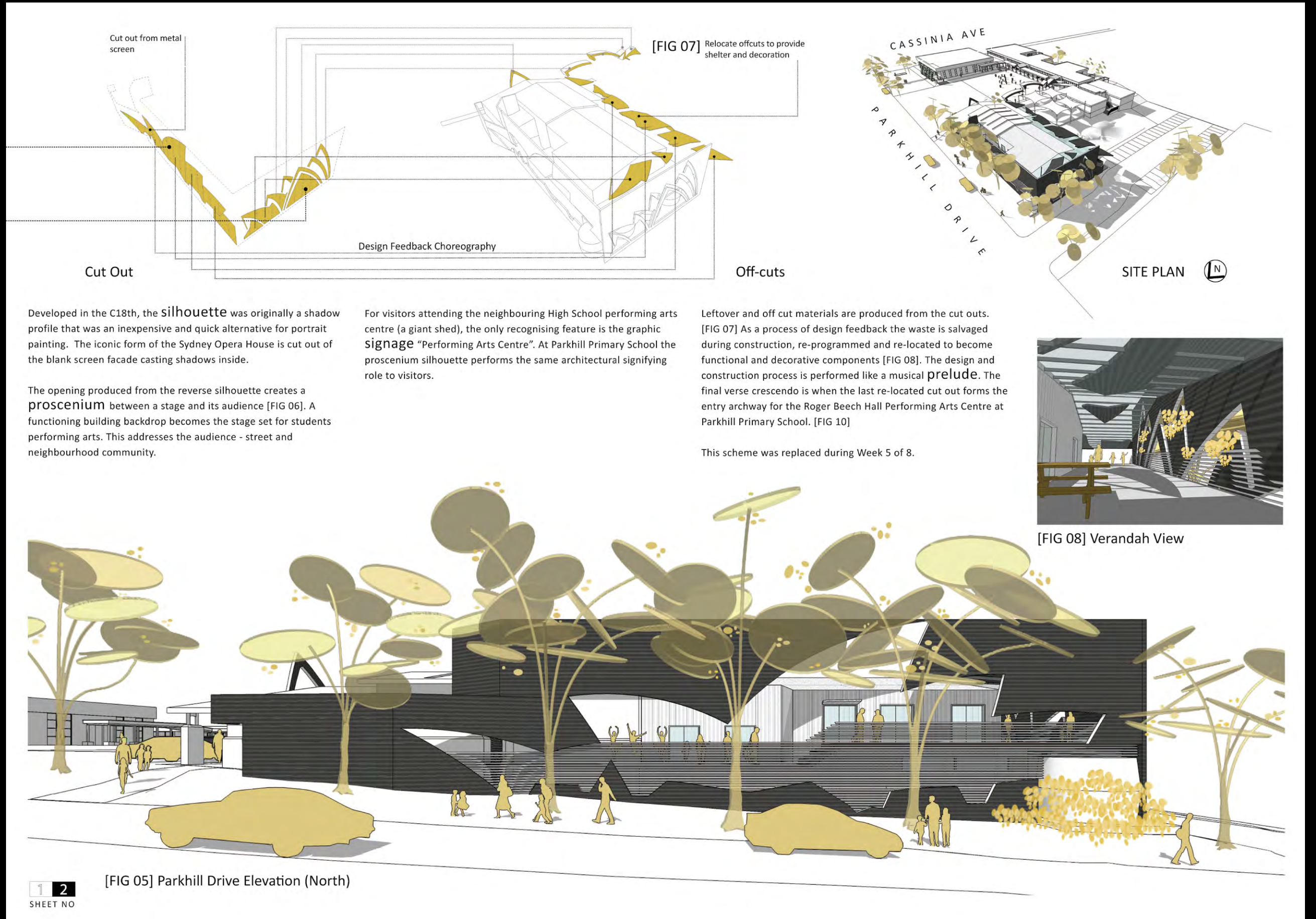

Developed in the C18th, the **silhouette** was originally a shadow profile that was an inexpensive and quick alternative for portrait painting. The iconic form of the Sydney Opera House is cut out of the blank screen facade casting shadows inside.

The opening produced from the reverse silhouette creates a **proscenium** between a stage and its audience [FIG 06]. A functioning building backdrop becomes the stage set for students performing arts. This addresses the audience - street and neighbourhood community.

For visitors attending the neighbouring High School performing arts centre (a giant shed), the only recognising feature is the graphic **signage** "Performing Arts Centre". At Parkhill Primary School the proscenium silhouette performs the same architectural signifying role to visitors.

Leftover and off cut materials are produced from the cut outs. [FIG 07] As a process of design feedback the waste is salvaged during construction, re-programmed and re-located to become functional and decorative components [FIG 08]. The design and construction process is performed like a musical **prelude**. The final verse crescendo is when the last re-located cut out forms the entry archway for the Roger Beech Hall Performing Arts Centre at Parkhill Primary School. [FIG 10]

This scheme was replaced during Week 5 of 8.

[FIG 05] Parkhill Drive Elevation (North)

[FIG 08] Verandah View